

Mounting Instruction

Duplo Mini Welding Device

Content:

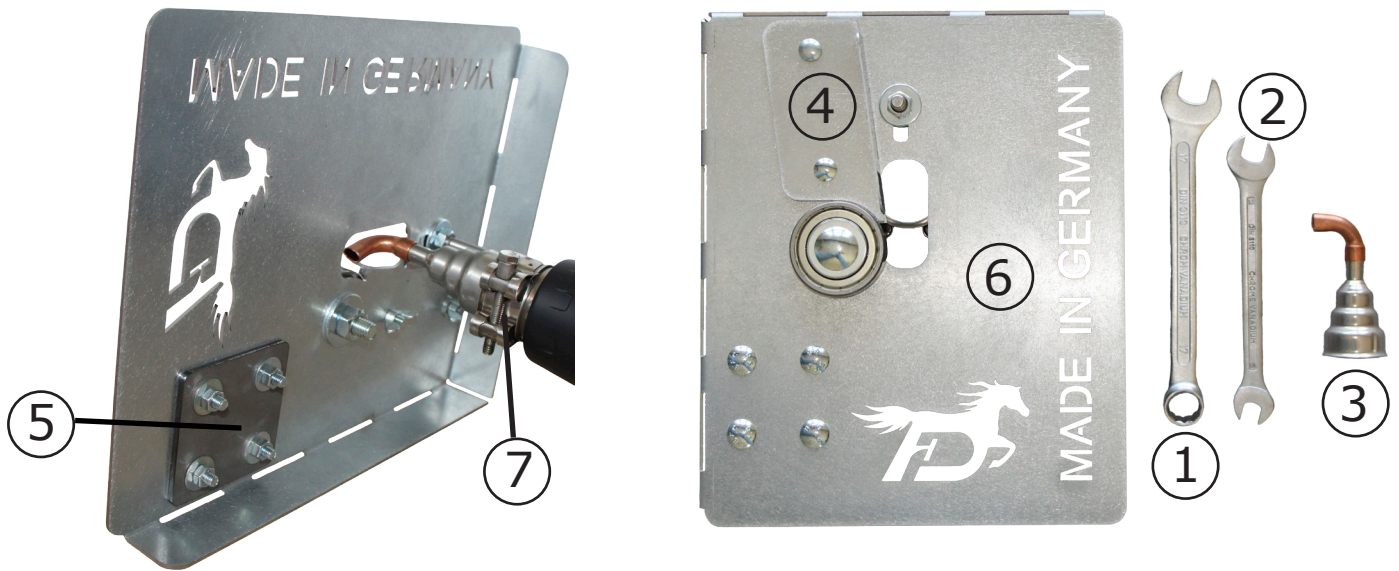

- ① combination spanner wrench 17mm
- ② open-end wrench 10/13mm
- ③ reduction nozzle 9mm with special attachment
- ④ 2x distance piece 2mm
- ⑤ tinkering piece
- ⑥ welding board with Duplo logo
- ⑦ mount for the hot-air gun

Put the nozzle (no. **3**) on your hot-air gun (type Steinel). Position the hot-air gun in its mount (no. **7**) under the welding board (no. **6**). Use the open-end wrench (no. **2**) for fastening the hot-air gun. Tighten it hand-tight.

Attention: The hot-air gun gets very hot. Do not push it completely up against the mount.



You can also vary the position of the hot-air gun on the upper side of the welding board. Use the combination spanner wrench 13mm (no. **2**) to unfasten the nut. Reposition the hot-air gun along the hole and re-tighten the nut hand-tight.

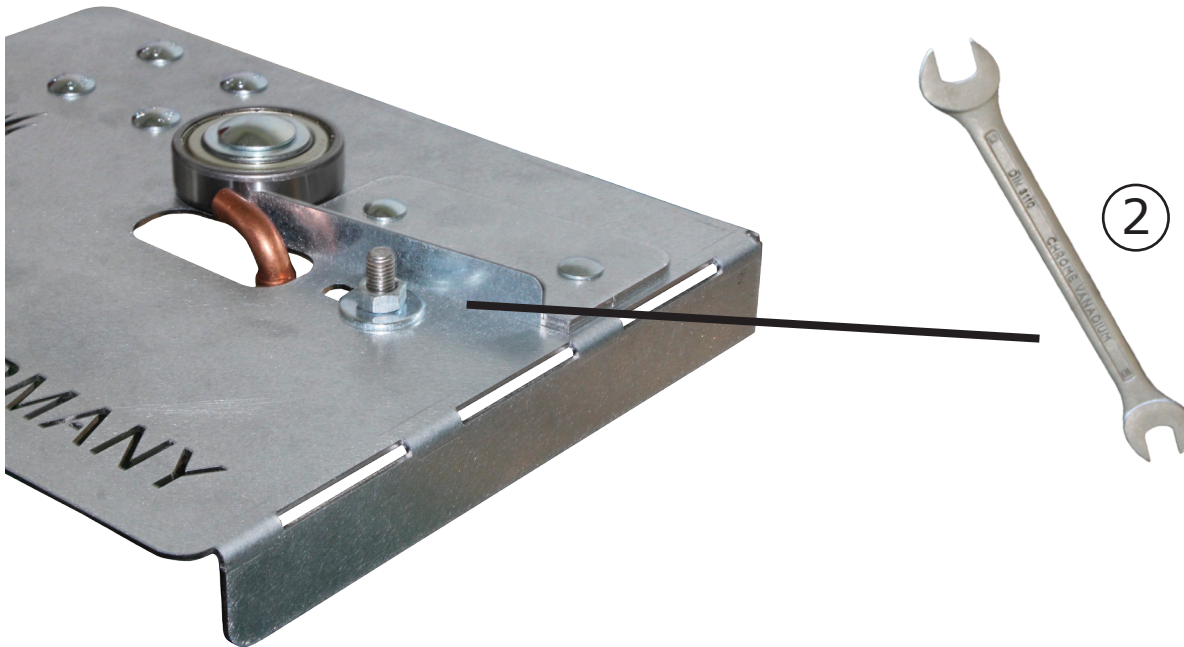

We recommend placing both distance pieces (no. **4**) on top of each other for welding glue-on tabs to a Duplo horseshoe. For welding color strips, the horseshoe and the color strip should be on the same height; we recommend not using a distance piece (no. **4**) in that case.

Recommendation: You can modify the mini welding device by using the non-galvanized tinkering piece (no. **5**) that is fixated under the welding board.